

Assembly Exploded Diagram

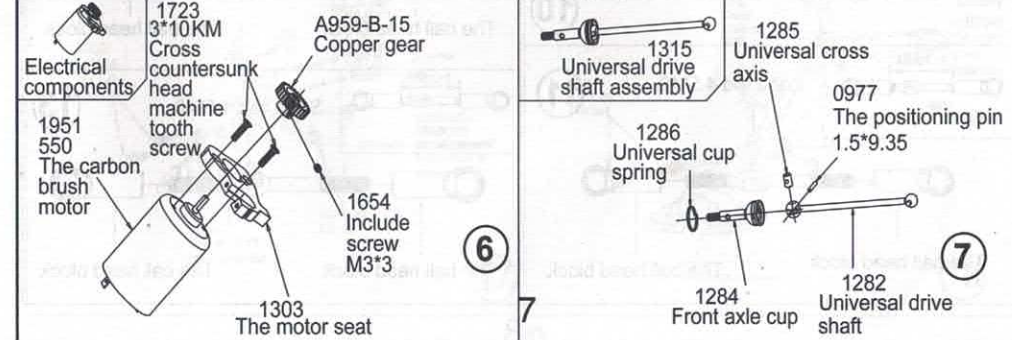

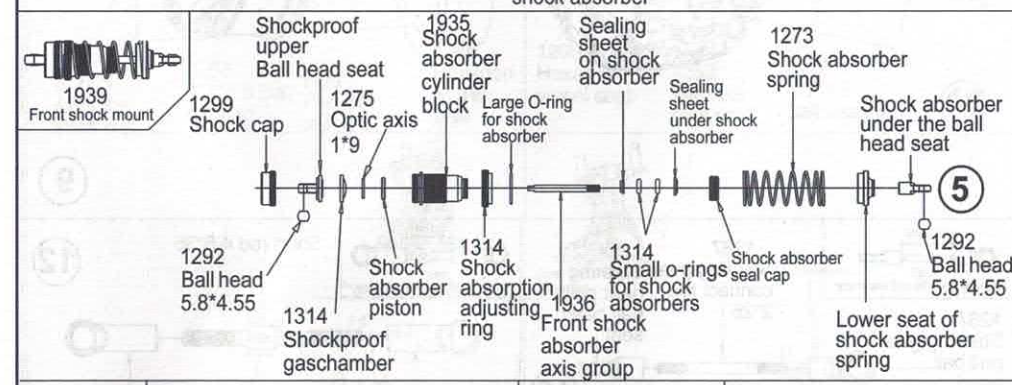

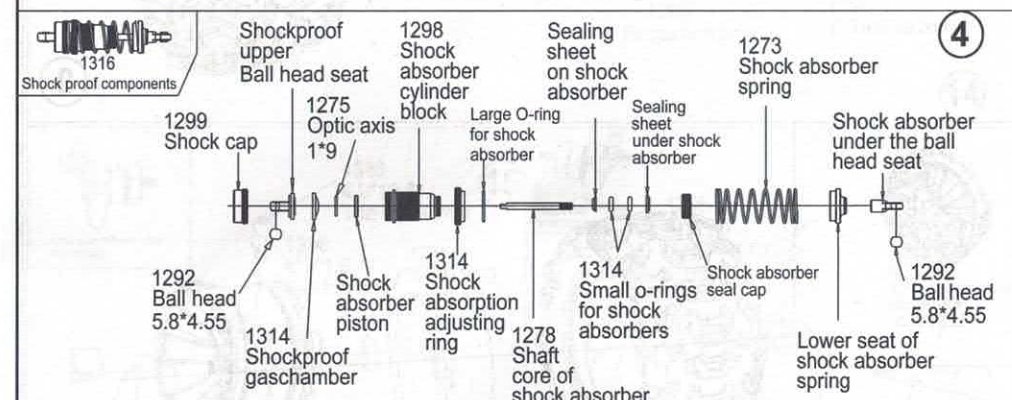
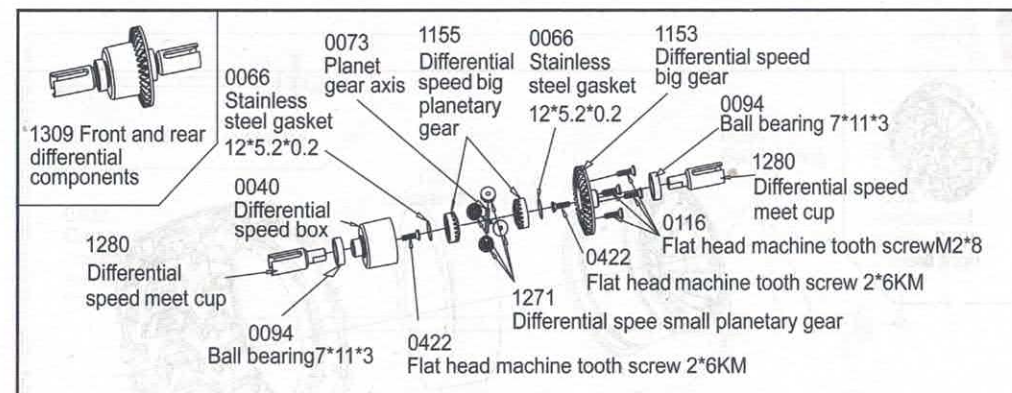
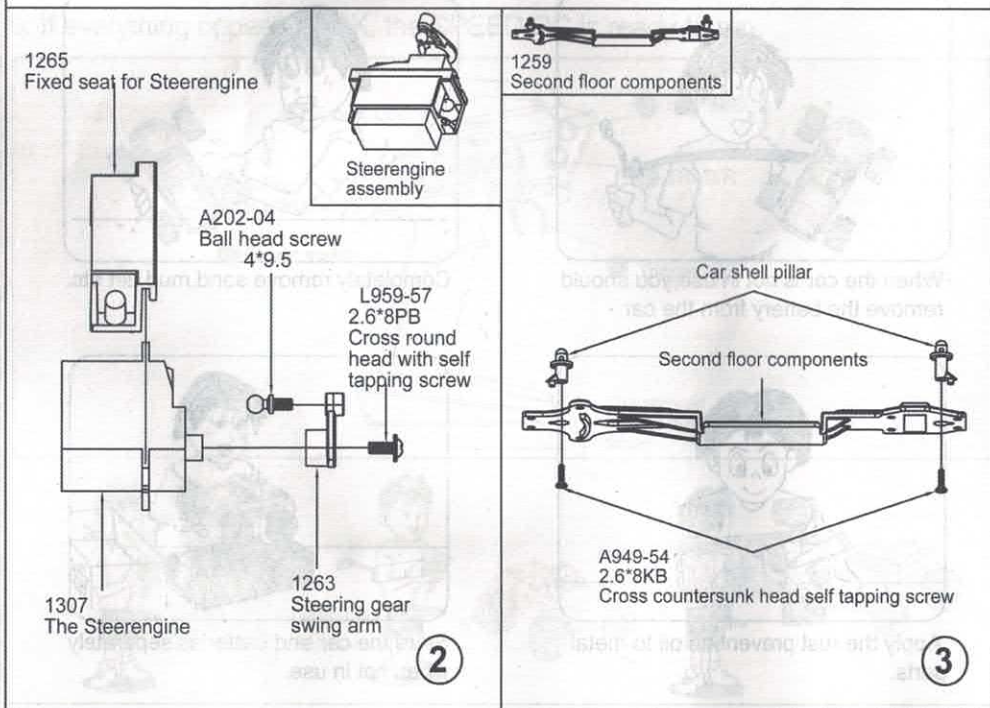
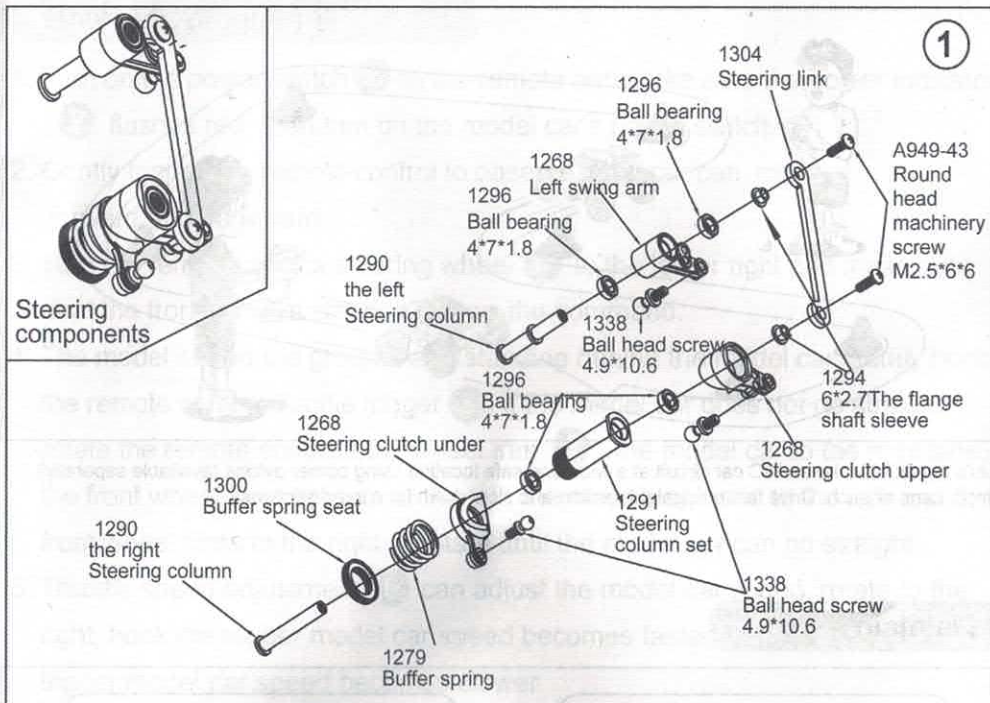
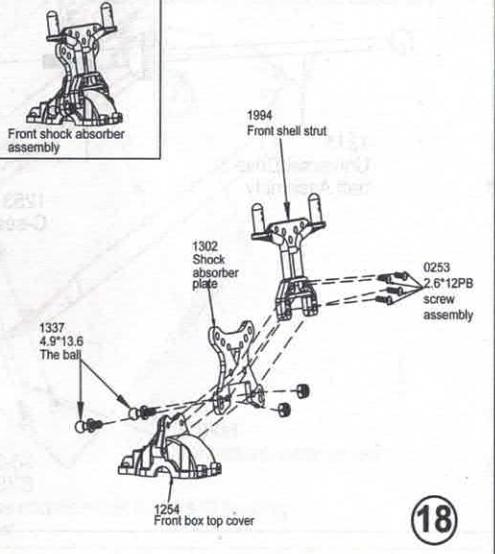
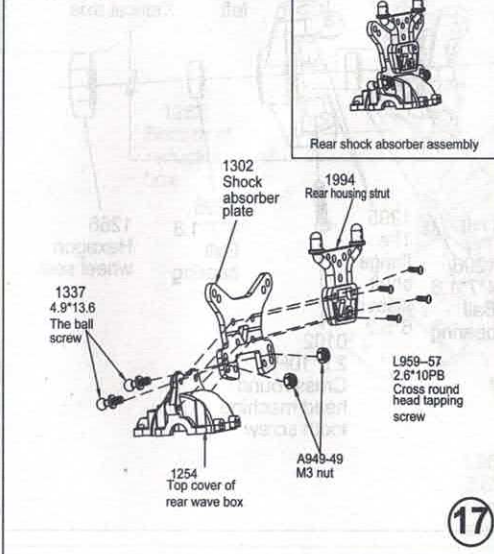
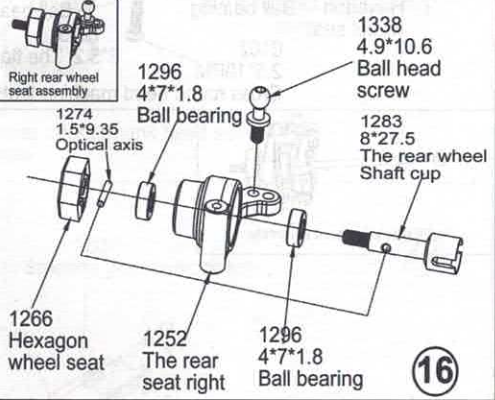
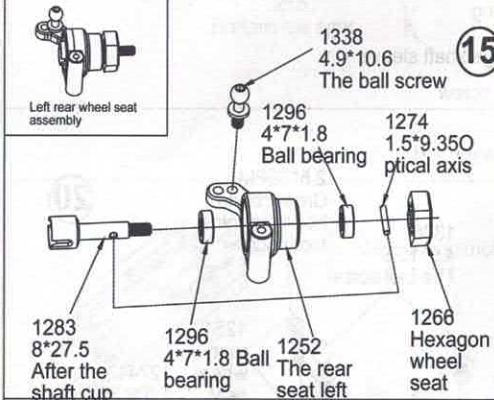
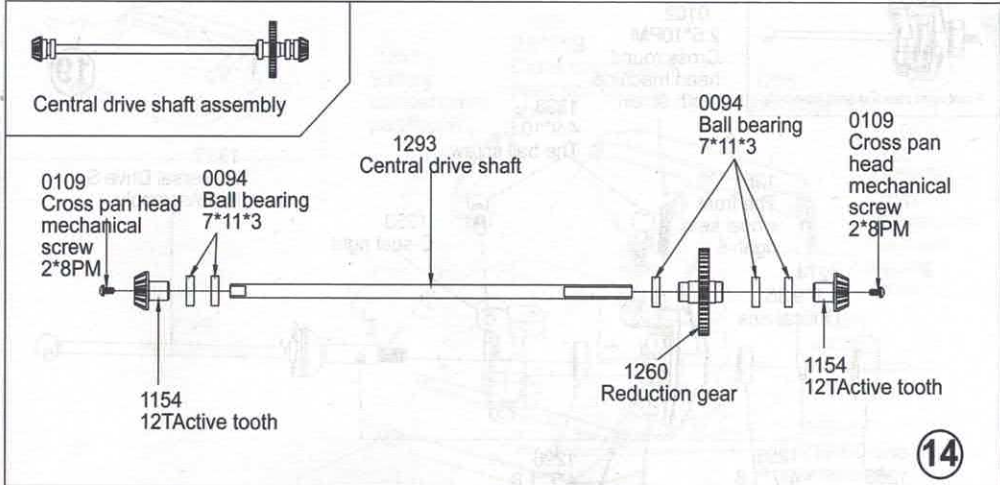
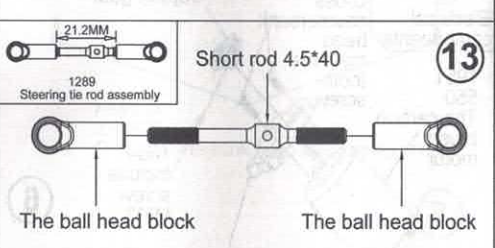
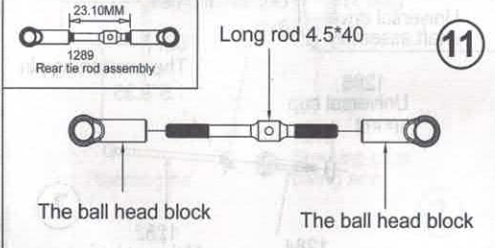
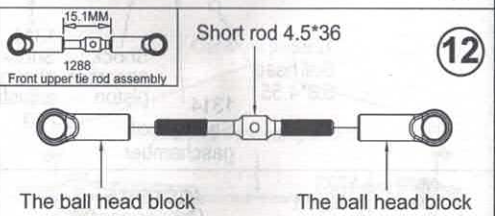
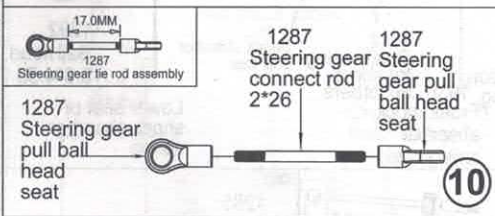
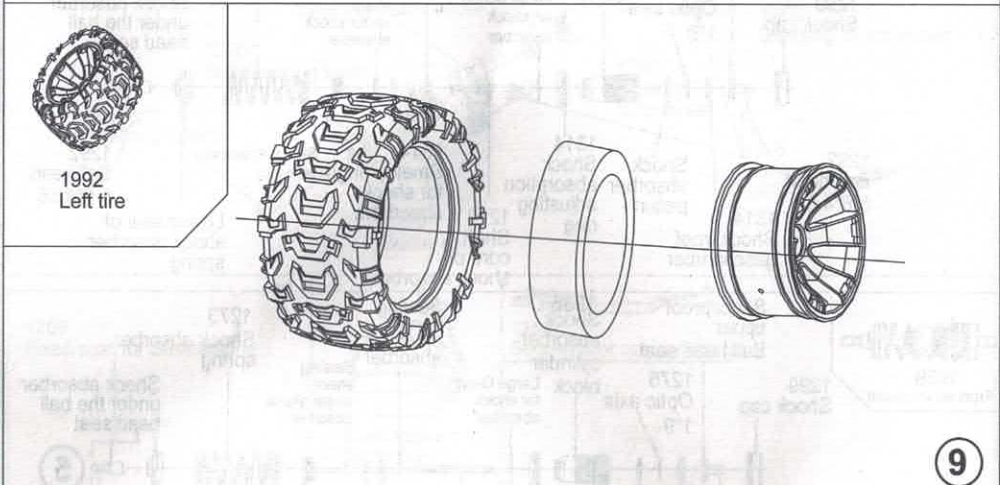
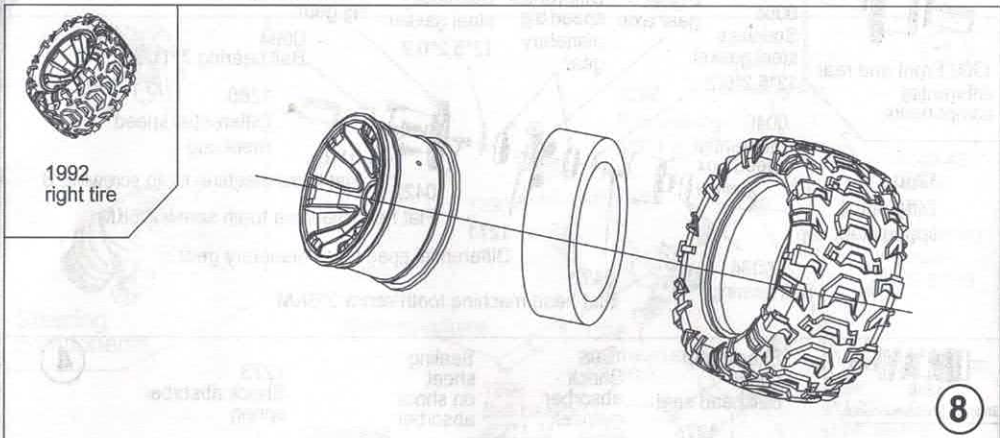
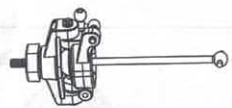

Front right steering seat assembly

0102
2.5*10PM
Cross round
head machine
tooth screw

19

1251
The front
wheel seat
right

1338
4.9*10.6
The ball screw

1315
Universal Drive S
haft Assembly

1253
C-seat right

1274
1.5*9.35
Optical axis

1296
4*7*1.8
Ball bearing

1296
4*7*1.8
Ball bearing

1266
Hexagon
wheel seat

1295

1295

6*5.2 The flange shaft sleeve

0102

2.5*10PM
Cross round head machine tooth screw

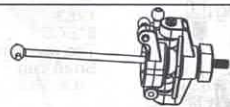

Front turn left to seat assembly

0102
2.5*10PM
Cross round
head machine
tooth screw

20

1338
4.9*10.6
The ball screw

1251
ront wheel
seat left

1274
1.5*9.35
Optical axis

1315
Universal Drive S
haft Assembly

1253
C-seat left

1295
The
flange
shaft
sleeve
6*5.2

1296
4*7*1.8
Ball
bearing

1266
Hexagon
wheel seat

1296
4*7*1.8
Ball
bearing

0102
2.5*10PM
Cross round
head machine
tooth screw

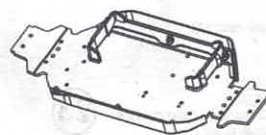

1261
Battery
compartment
partition-A

1323
2.6*5KB
Cross countersunk
head self tapping
screw

1255
Bottom edge left

21

1323
2.6*5KB
Cross
countersunk
head self
tapping
screw

1261
Battery
compartment
partition-B

L959-54
2.6*8KB
Cross
countersunk
head self tapping
screw

1249
Vehicle bottom

1255
Bottom rail right

1323
2.6*5KB Cross countersunk head self tapping screw

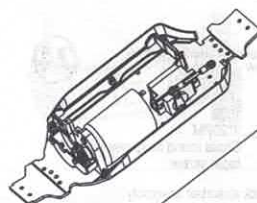

Motor assembly

1307
Steering gear components

22

1287
Steering gear tie rod assembly

1262
Bottom of
reduction gear
box

L959-54
2.6*8KB
Cross countersunk head self tapping screw

0114
2.5*8KM
Countersunk hear screw

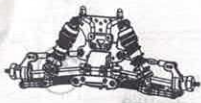

Rear wave box assembly

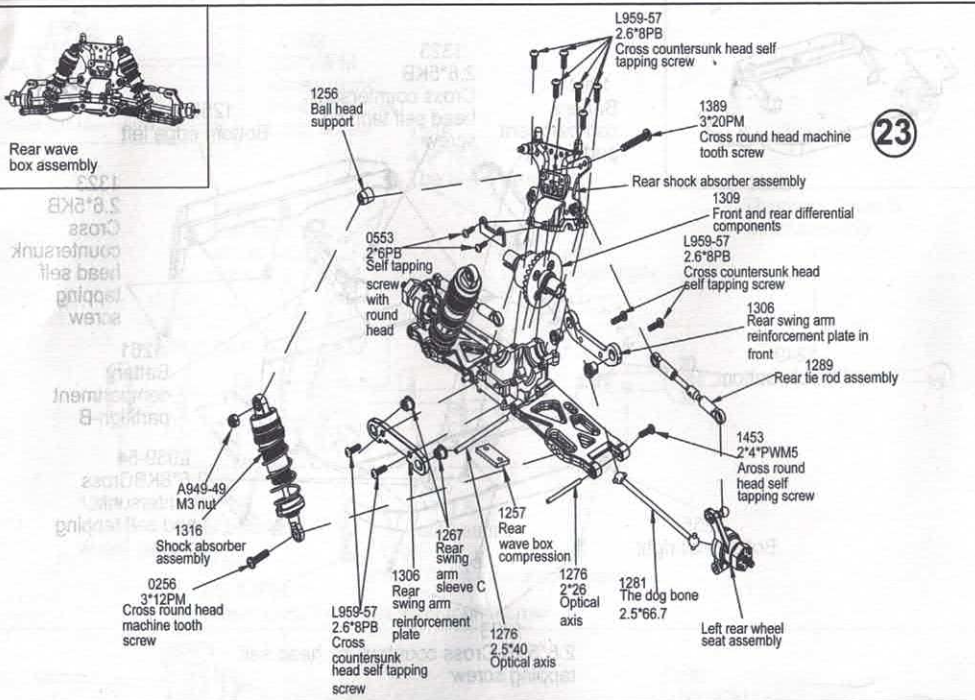

Front wave box assembly

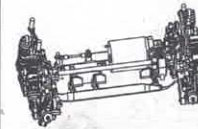
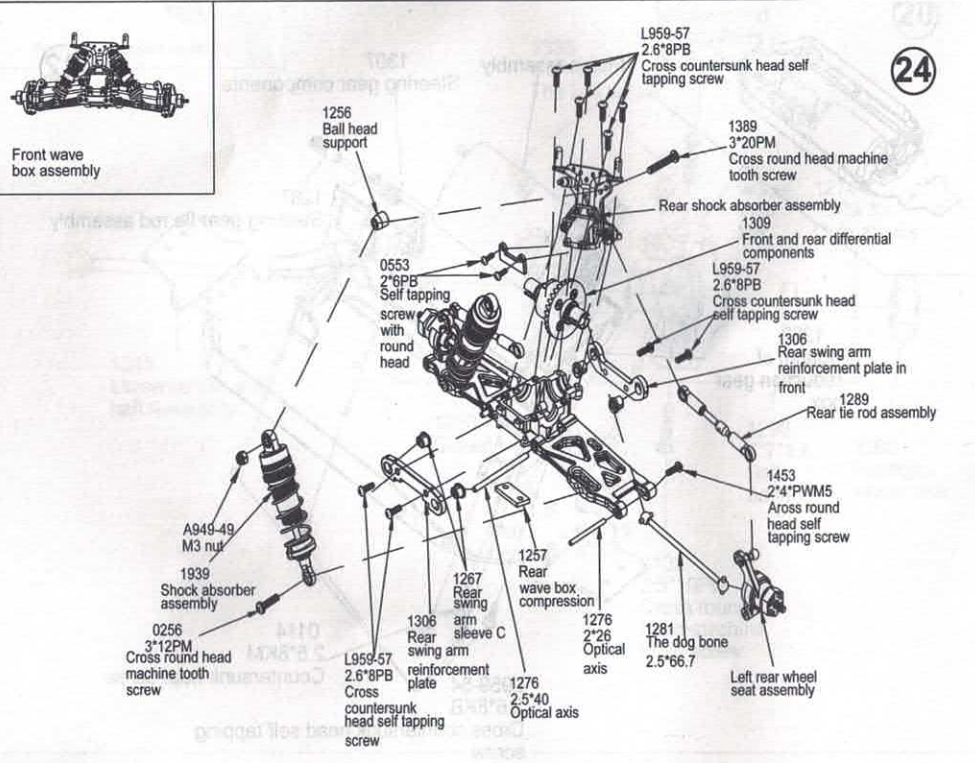

1262 Reduction gear cover

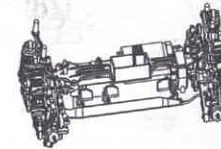
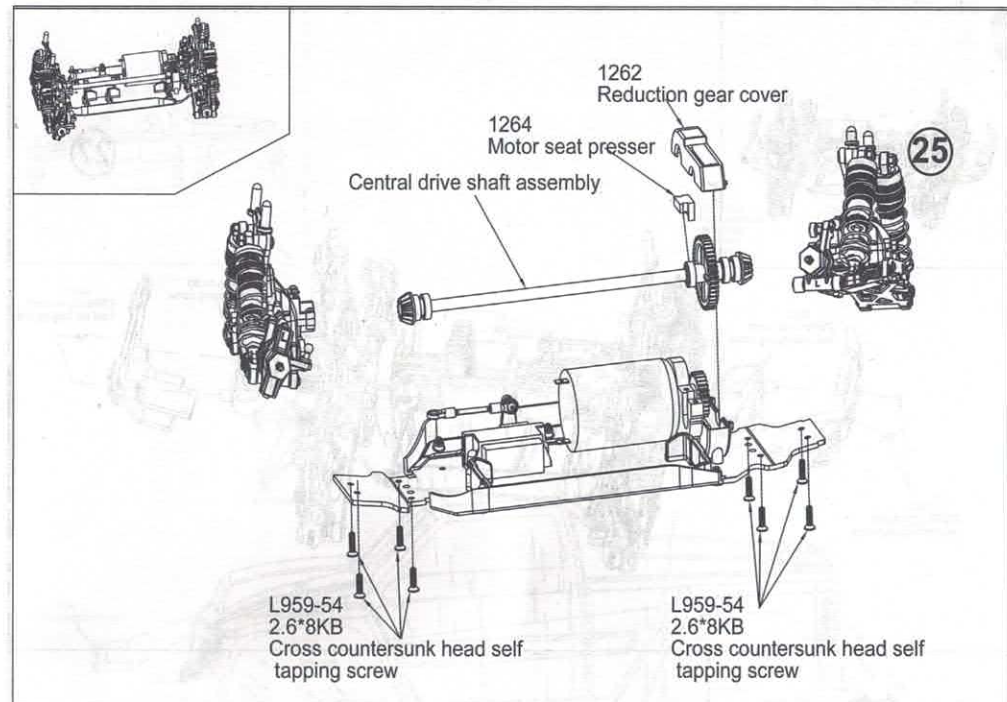

A949-43 2.5*6PWM6 Cross round head machine tooth screw

1311 Receiver panel assembly

A949-43 2.5*6PWM6 Cross round head machine tooth screw

A949-38 2.6*6PB Self tapping screw with round head

26

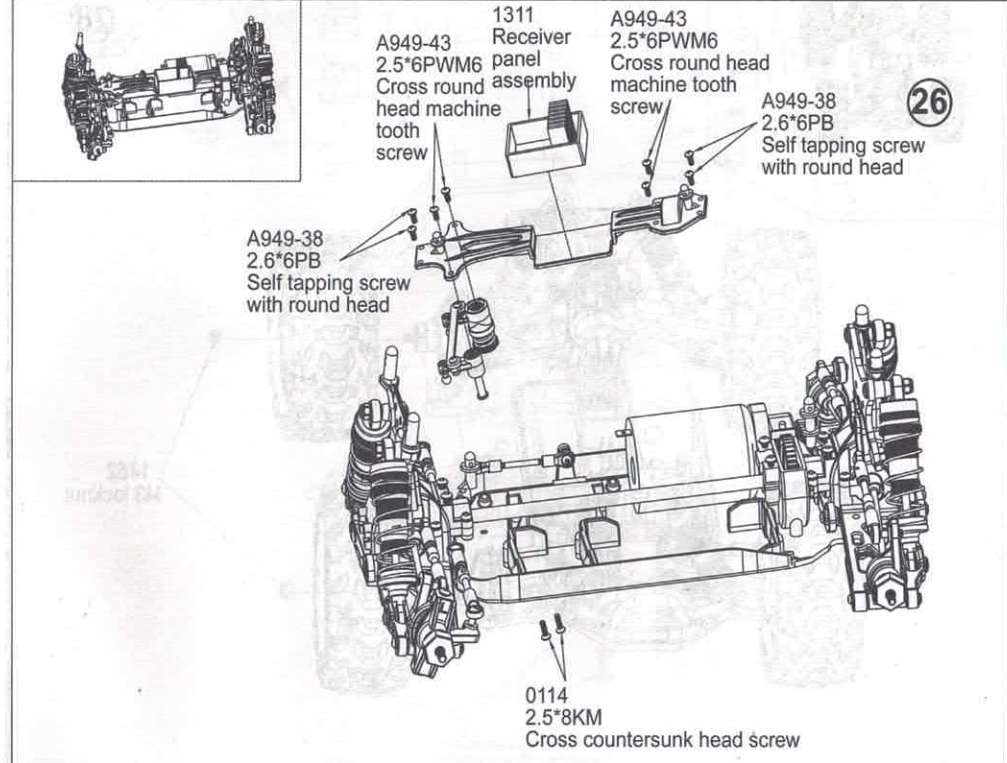

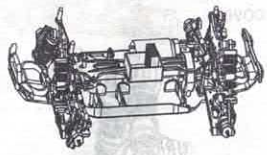

27

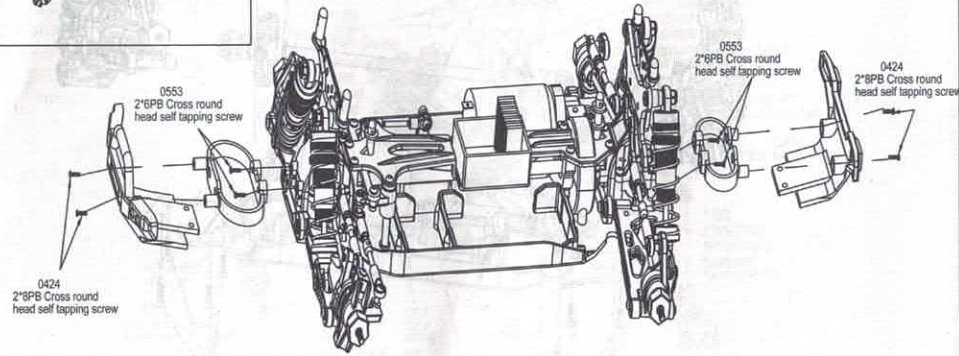

0424 2"8PB Cross round head self tapping screw



28

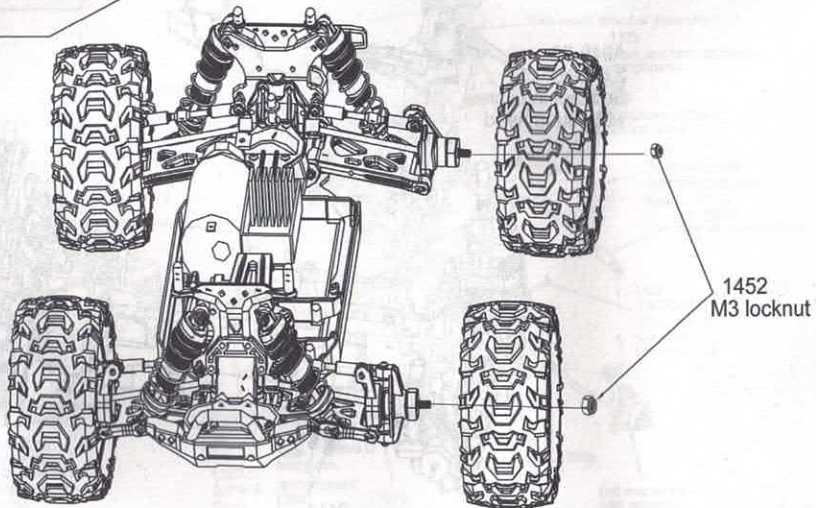

14

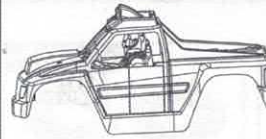

29

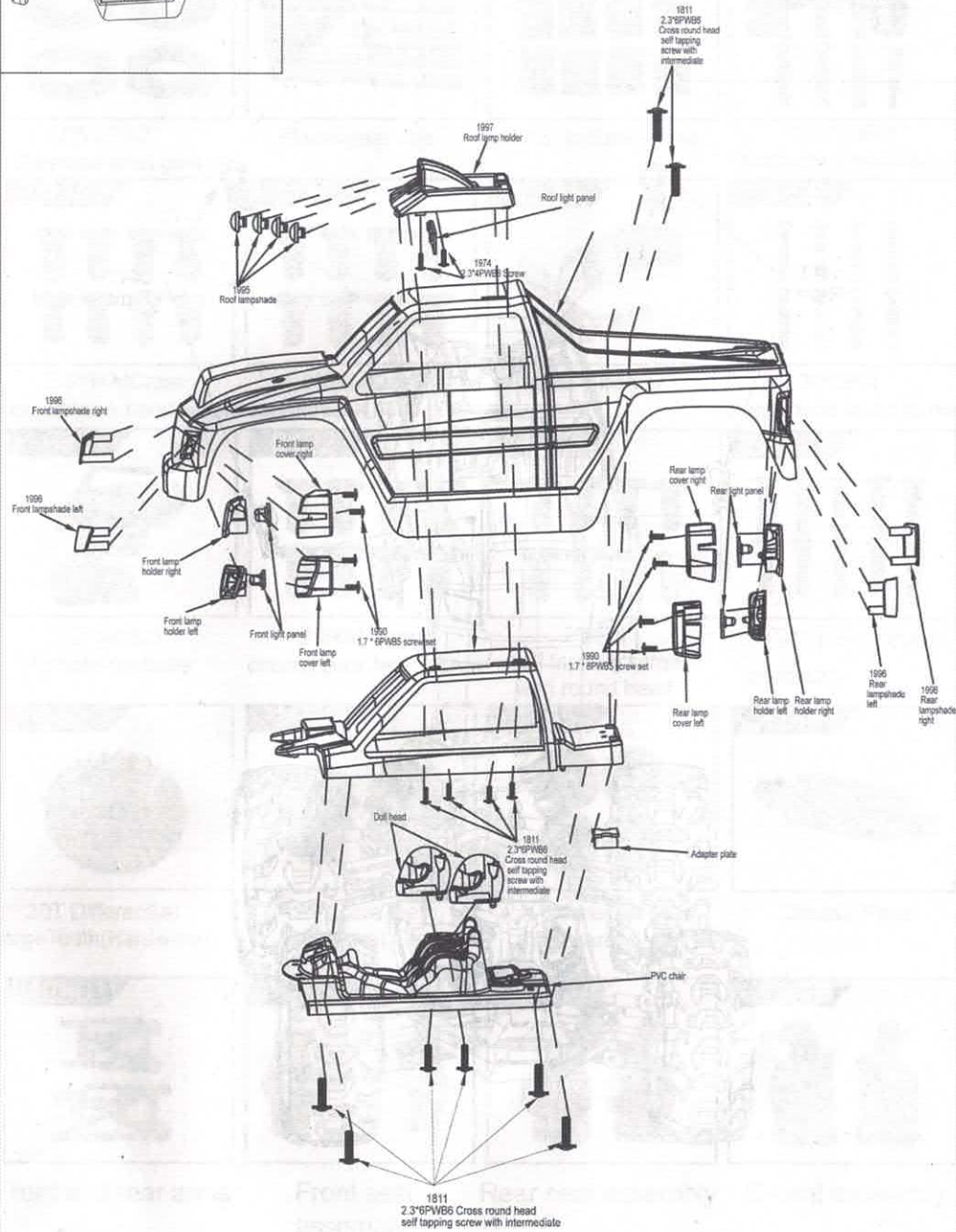

1811 2.3"6PW86 Cross round head self tapping screw with intermediate

15



30

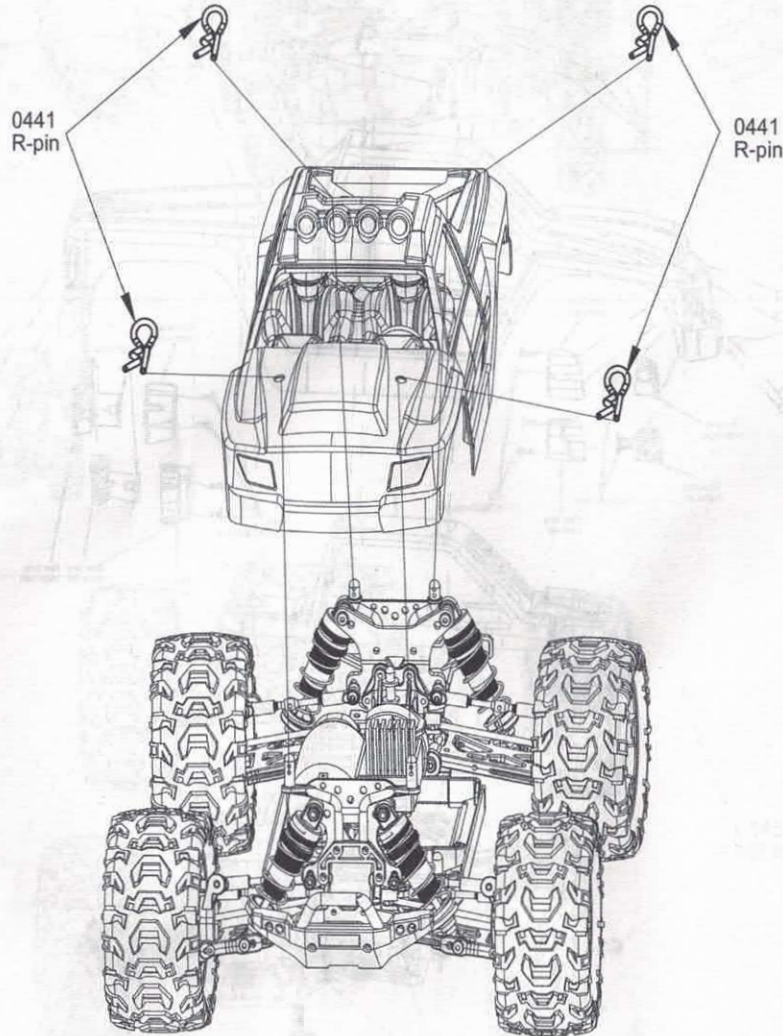

Sale parts view

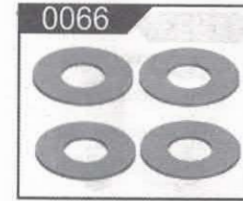

0066
12*5.2*0.2
Stainless steel gasket

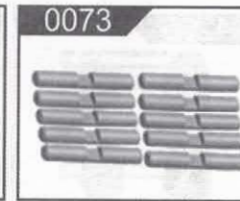

0073
Planet gear axis



0098
M3*3 Include screw

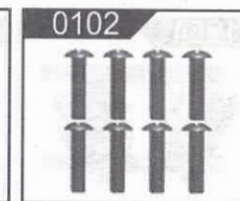

0102
2.5*10PM
Cross round head screw

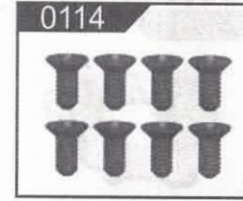

0114
2.5*8KM Cross
countersunk head screw



0117
3*8KM Cross
countersunk head screw

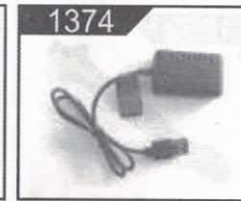

1374
USB Charger

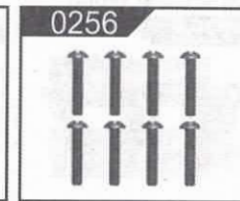

0256
3*12PM
Cross round head screw



1669
V2-144001
Remote controller



0422
2*6KM Cross
countersunk head screw



0553
2*6PB
self tapping screw
with round head

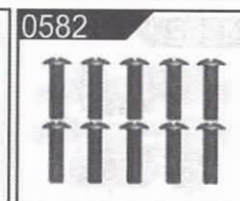

0582
ST2*7PB screw
assembly

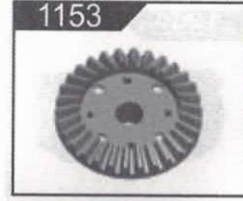

1153
30T Differential
largeTeeth(Hardware)



1154
12T ActiveTeeth
(Hardware) Grou

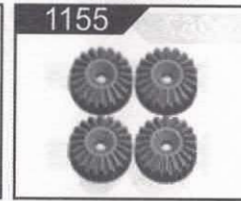

1155
24t differential gear
(hardware) group

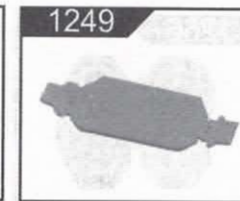

1249
Chassis Plate



1250
Front and rear arms



1251
Front seat
assembly



1252
Rear seat assembly



1253
C-seat assembly

Sale parts view



1254
Wave box upper and lower cover group



1255
Left and right sides

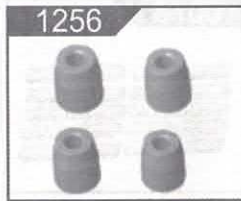

1256
Support piece as-ball head

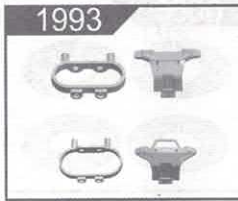

1993
Front and rear anti-collision groups



1258
Tail firmware Wing group

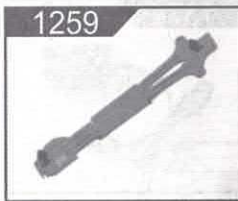

1259
Two floor group

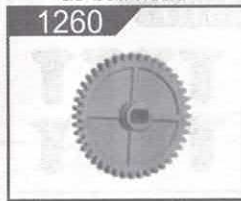

1260
Gear reducer gear



1261
Battery holder



1262
Reduction gearbox



1263
Rocker arm of steering gear

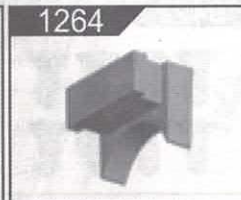

1264
Motor seat pressure piece

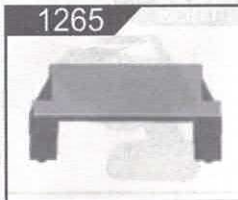

1265
Steering gear base



1266
hub drive hex

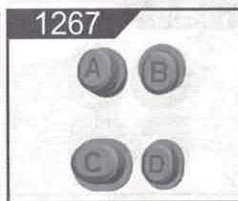

1267
Front and rear swing arm shaft sleeve



1268
Steering clutch group

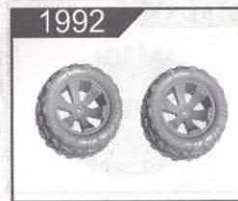

1992
The left tire group



1998
The right tire group

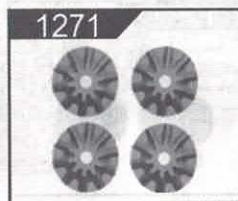

1271
10T Differential Astero Teeth (Hardware) Group

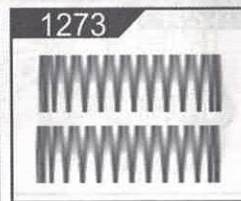

1273
Shock absorber spring

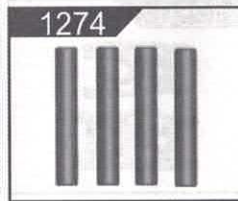

1274
1.5*9.35 universal shaft group

Sale parts view

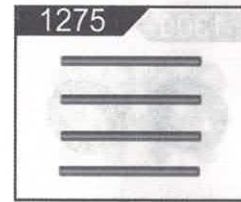

1275
1*9 Optic axis

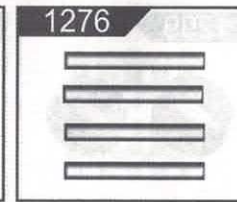

1276
2.5*40 Optical axis



1277
2 * 26 Optical axis

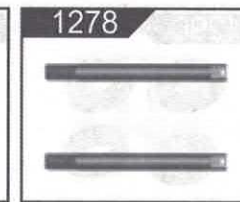

1278
Shock absorber shaft component



1279
Buffer spring assembly



1281
Dog bone assembly



1282
universal shaft assembly



1283
Rear Wheel Cup Component



1284
Front Wheel axis Component

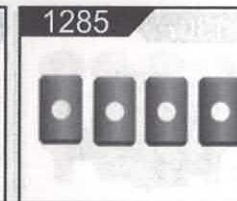

1285
Cross shaft assembly



1286
Universal cup spring assembly

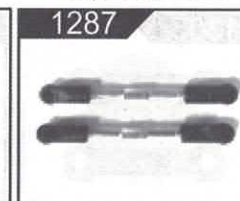

1287
Steering gear lever assembly

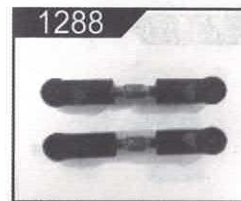

1288
Short pull bar assembly

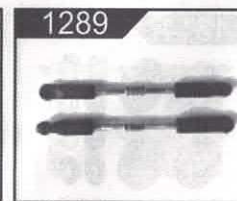

1289
Long pull bar assembly

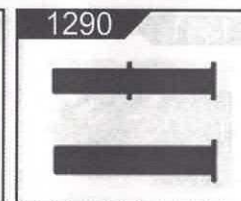

1290
Steering column assembly



1291
Steering column sleeve component

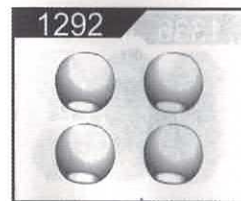

1292
Ball head group



1293
Central Transmission Axis Component

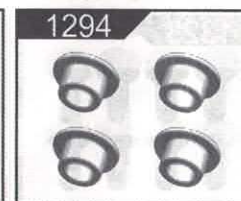

1294
6*2.7 Flange axis sleeve



1295
6*5.2 Flange axis sleeve

Sale parts view



1296



4*7*1.8
Ball bearing set

1298



Cylinder as-shock
absorber

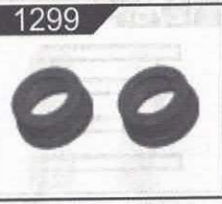

1299

Shockproof hat group

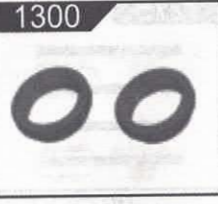

1300

Adjusting ring group

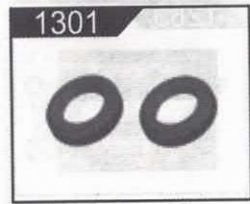

1301

Spring seat



1302

Shock absorber plate group



1303

Motor seat



1304

Steering linkage

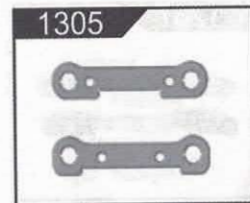

1305

Front swing arm
reinforcement



1306

Rear swing arm
reinforcement



1307

Steering gear



1951

Motor



1309

Differential



1311

Receiving board
assembly

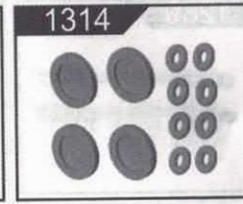

1314

O-ring as-shock

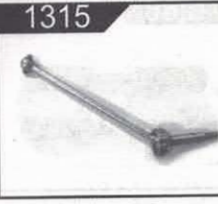

1315

Universal drive shaft



1316

Shock absorber

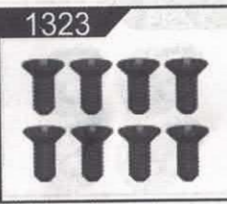

1323

2.6*5KB
Countersunk head
tapping screw



1991

Car shell
components

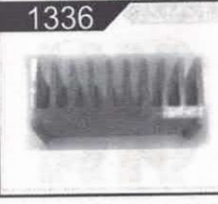

1336

Heat sink

Sale parts view



1337

4.9*13.6
Ball head screw set

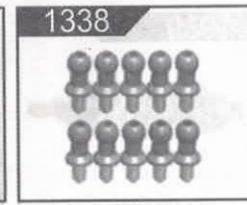

1338

4.9*10.6
Ball head screw set



A202-04

4.0*9.5
Ball head screw set



A202-15

2*8KB Cross
countersunk head screw set

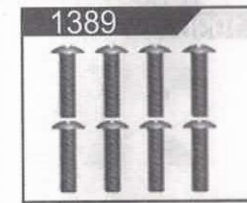

1389

3*20PM Cross round head
machine tooth

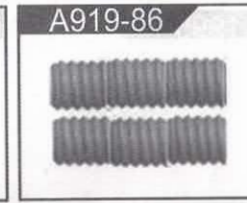

A919-86

Machine screw set



A949-22

Velcro



A949-35

7*11*3
Ball bearing



A949-38

2.6*6PB Round head self
tapping screw



A949-43

M2.5*6*6
Round head belt screw



A949-49

M3 Nut



A959-B-15

Motor gear



A959-B-23

Battery

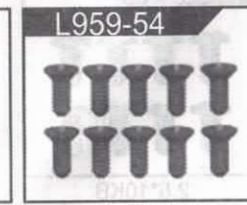

L959-54

2.6*8KB
Countersunk head
tapping screw

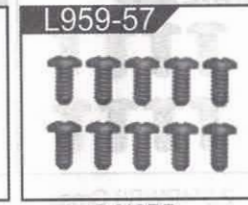

L959-57

2.6*8PB
Round head self
tapping screw

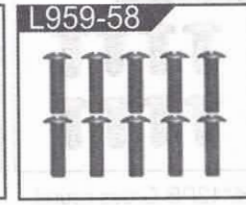

L959-58

ST2.6*10 PB
screwassembly

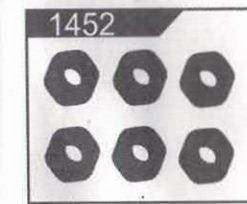

1452

M3 flange nut

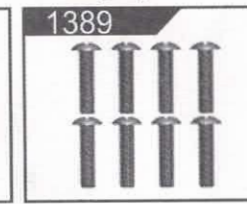

1389

3 * 20pm Cross
round head
machine screw



1453











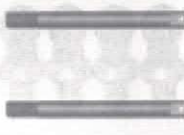

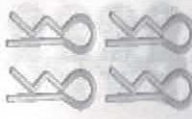

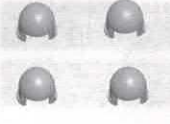



2*4PWM5
Cross round head
machine screw



1656

2.5*8PWM6
Cross round head
machine screw

Sale parts view

<p>1935</p> 	<p>1936</p> 	<p>1939</p> 	<p>0441</p> 
<p>Front shock block group</p>	<p>Front shock absorber axis group</p>	<p>Front shock mount</p>	<p>1.0*18 R Type Pin</p>
<p>1280</p> 	<p>1994</p> 	<p>1995</p> 	<p>1996</p> 
<p>Cup as-differential</p>	<p>Shell support group</p>	<p>Roof lampshade group</p>	<p>Front and rear lampshade group</p>
<p>1997</p> 	<p>1989</p> 	<p>1990</p> 	<p>1811</p> 
<p>Roof light frame group</p>	<p>Zinc alloy cross sleeve set</p>	<p>1.7*6 PWB5 screw group</p>	<p>2.3*6PWB6 Cross head with medium screw</p>
<p>0253</p> 	<p>1974</p> 	<p>1999</p> 	
<p>2.6*12PB Cross round head tapping screw</p>	<p>2.3*4PWB8 Cross head with medium screw</p>	<p>2.6*10KB Countersunk head tapping screw</p>	
			

1:14 Electric four drive big-legged car

14+



Caution: This model is not a toy, it is designed for user over 14 years of age. Please use this instruction and the R/C system instruction at the same time. The instruction is suitable for a type of model whose number is 144002